

Rinnai | IMPRESSION OUTDOOR FIRE



Designed to Impress

Rinnai | IMPRESSION OUTDOOR FIRE

As day turns into night, the Rinnai Impression Outdoor Fire becomes the centre piece of open-air entertaining. Its warmth and beauty provides comfort to extend gatherings, long into the evening.

An affordable Outdoor Fire with a flexible design

The new Rinnai Impression Outdoor Fire has been cleverly designed to suit your outdoor living environment. Its modular design and gas bottle connection makes it affordable, very easy to install, and will make your outdoor living area come to life.



Benefits at a glance

- Add style, and warmth to your outdoor living area.
- The modular design offers design flexibility.
- Easy installation.
- Units run on a 9 Kg LPG gas bottle so it has a simple, economical fuel source.
- Simple operation.
- Constructed with quality materials to ensure durability for years to come.
- Made in New Zealand to withstand our unique conditions.
- The Impression balances style and high-technology with value for money.

The Outdoor Fire made for New Zealand

New Zealanders love spending time in the great outdoors, whether it's soaking in the scenery, or enjoying a meal alfresco with friends. That's why the new Rinnai Impression Outdoor Fire is a perfect fit for this lifestyle. Designed and made in New Zealand for our climate, this high-quality outdoor fire will ensure evenings outdoors are a pleasure.



Easy installation for any setting

The Impression range of one-sided, two-sided or the freestanding table-top units, provide options for every outdoor setting. As the units are modular they can be adapted to fit into any permanent structure, so you will have these quality outdoor fires installed and functioning in no time and their durable construction ensures they will last through many years of entertaining.

A combination of style and strength

Constructed with stainless steel, aluminium extrusion, natural granite and quartz, the Rinnai Impression Outdoor Fire is both strong and attractive. For added protection, a high-temperature powder-coated finish has also been added in areas where it is needed most.

But perhaps most inspiring of all, is that each of the units can be clad to match your outdoor setting. It's easy to personalise your unit by cladding it in materials such as stone, plaster or brick, and make a style statement.

Simple operation

Similar to regular BBQ's, Rinnai Impression Outdoor Fire connects to a 9 Kg LPG bottle with a quick disconnect gas connection. It has three flame settings, accessed by the control knob on the front of the fire and Piezo ignition so it's reliable and easy to use.

As with all Rinnai appliances, the Outdoor Fire meets all the safety standards required by New Zealand gas regulations. It also has a burner that lights with a low gas rate* (it lights to pilot) and a flame failure device. This ensures that if the fire is on and there is no flame, the gas will automatically shut off.

Rinnai making daily life a pleasure

These impressive outdoor fires are just one of the quality products that you'll discover with Rinnai. In fact Rinnai have an extensive range of products for your home including solutions for water heating, space heating, indoor flame fires and state-of-the-art BBQs. Now you can have a range of smart, stylish products to keep you comfortable inside and outside your home all-year-round.

*Gas consumption – high to low, 45-25 MJ/h (ULPG, Universal LPG).

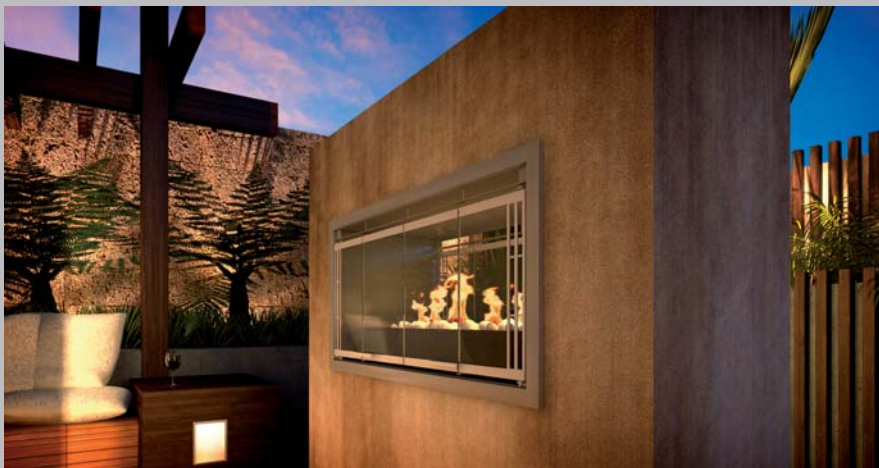

Open see through cabinet

If you're seeking a simple, clean design, Rinnai's double sided cabinet is a good choice. Flames are viewed from both sides, and creates a feeling of space being able to see through to the other side.



Single sided cabinet

The unit offers the flexibility to be built into the outside of your home, or in a stand-alone location at the end of your deck. Whatever you choose, it will add style to your outdoor setting.



Freestander

When evening comes, the freestanding table-top unit is an impressive sight. Flames of fire cover the unit top, providing a focal point where your guests are sure to gather. The table-top can be built into a stand or secured into a permanent fixture in your outdoor area.

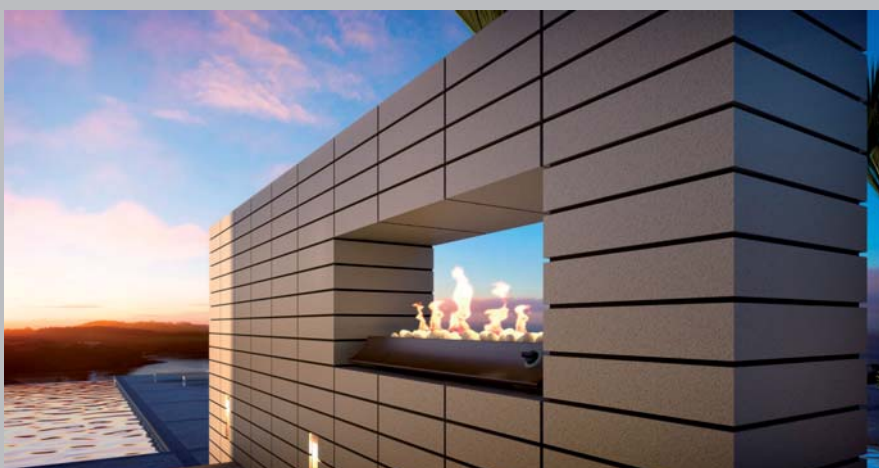

Masonry installation

With a dramatic look the freestander unit can be encased in a masonry installation, so you can view the fire from either one or both sides.

Types of installation options.

Rinnai | IMPRESSION OUTDOOR FIRE

The Rinnai Outdoor Fire is designed to be built into a permanent fixture. The below table details the available installation options, components needed and optional accessories.

Installation Options				
Components needed	Freestander *	Single sided cabinet *	Open see-through cabinet *	Non-combustible enclosed masonry *
Burner assembly LPG** (ROF4500)	✓	—	—	✓
1-Sided burner/ Body assembly LPG** (ROF4501)	—	✓	—	—
2-Sided burner/ Body Assembly LPG** (ROF4502)	—	—	✓	—
Optional Accessories				
Glass bi-fold door assembly (R2612)	—	✓	✓	—
NG conversion kit (R2620)	✓	✓	✓	✓

Suitable for installations using cladding and finishes that can withstand temperatures up to 100°C,
* Surrounds of fire not included ** See drawings below for dimensions of each outdoor fire.

Freestander and non-combustible enclosed masonry

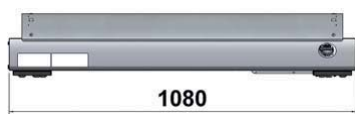

Burner Assembly - 20 kg

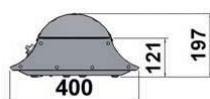

Single and open see through models

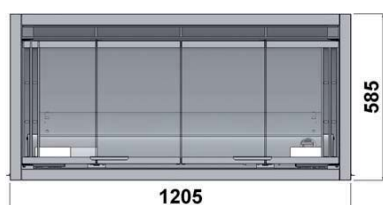

Burner and body assembly - 50 Kg (weight is not inclusive of door assembly shown)

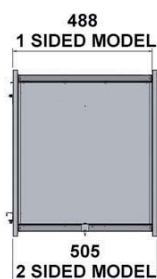

Modular steel framed console units available

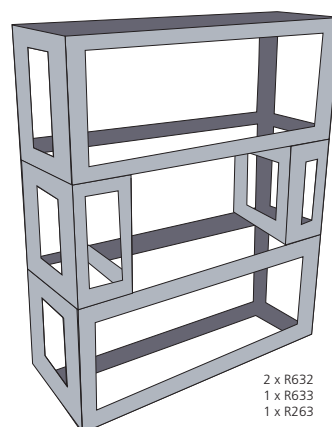

2 x R632
1 x R633
1 x R263

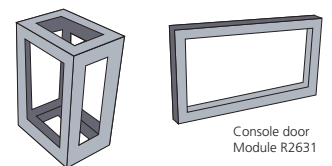

Console door
Module R2631

Console spacer module
R2633 (sold in pair)

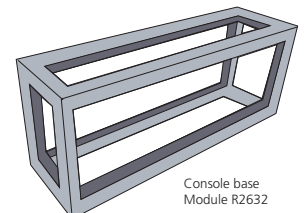

Console base
Module R2632

Steel framed console units can reduce installation time and provide flexibility of design. The console units are available as accessory items.